

Main Advantages

- ▶ Adopt tubular positive plate
- ▶ Longest lifespan under deep discharge
- ▶ Strong temperature resistance performance
- ▶ Better charge reception capability
- ▶ 20 years design life



Specification	
Rated Voltage	2V
Nominal Capacity(C10,1.80V/cell)	350Ah (35A to 1.80V @25°C)
Terminal	M8 Φ=20
Approx. Weight	Approx. 20.5Kg (dry cell: 19.8Kg)
Container Material	SAN transparent container
Max. Discharge Current	3400A (5 sec)
Internal resistance(25°C)	Approx 0.6 mΩ (fully charged)
Operating temperature range	Discharge: -20°C~55°C Charge : -10°C~45°C Storage : -15°C~45°C
Self discharge	≤3%/month @ 25°C
Design life	20 years (floating design)
Cycle use	
Charging current	≤87.5A
Voltage	2.35-2.40V/cell
Temperature compensation	-5mV/°C
Standby use	
Charging current	No limit
Voltage	2.23V/cell
Temperature compensation	-3mV/°C

Dimension:124(L)×206(W) ×471(H)×526(TH) Unit: mm

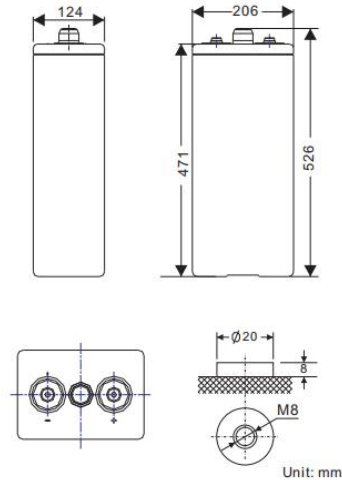

Rated Capacity(25°C)	
120 Hour Rate (4.14A to 1.85V)	496.8Ah
20 Hour Rate (21.72A to 1.8V)	434.4Ah
10 Hour Rate (36.97 to 1.8V)	369.7Ah
5 Hour Rate (63.14A to 1.75V)	315.7Ah
1 Hour Rate (212A to 1.60V)	212.0Ah

Constant Current Discharge Characteristics: A (25°C)

F.V/Ti me	30 min	1h	2h	3h	4h	5h	6h	8h	10h	24h	48h
1.60V	295	202	126	91	72	62	55	44.6	37.1	16.52	9.14
1.65V	285	197	123	89	72	62	54	44.3	36.9	16.52	9.07
1.70V	273	191	120	88	71	61	54	43.8	36.8	16.35	9.00
1.75V	263	186	117	86	69	60	53	43.0	36.2	16.07	8.89
1.80V	241	177	113	84	68	58	51	41.9	35.1	15.68	8.72
1.85V	214	164	107	81	66	57	49	40.7	34.7	15.19	8.30
1.95V	173	131	93	73	61	53	46	36.9	31.2	13.93	7.77

Constant Power Discharge Characteristics: W (25°C)

F.V/Time	30 min	1h	2h	3h	4h	5h	6h	8h	10h	24h	48h
1.60V	538	372	232	168	134	116	102	83.0	69.0	30.84	17.33
1.65V	525	364	228	166	133	114	101	82.4	68.7	30.77	17.26
1.70V	504	354	223	163	131	113	99	81.3	68.4	30.42	17.12
1.75V	487	345	218	160	129	111	98	80.2	67.7	30.17	17.05
1.80V	449	333	213	159	128	111	97	79.6	66.2	29.79	16.87
1.85V	406	312	204	156	126	109	95	78.1	66.5	29.44	16.38
1.95V	341	259	184	144	121	104	91	73.3	62.1	28.11	15.93

Disclaimer: Manufacturers have the right to self-modify the parameters of the product updates, please keep in touch with manufacturers to obtain the latest information.

Discharge Characteristics Curve

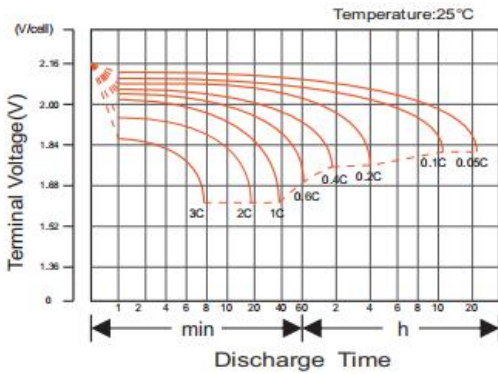

Charging Characteristics Curve

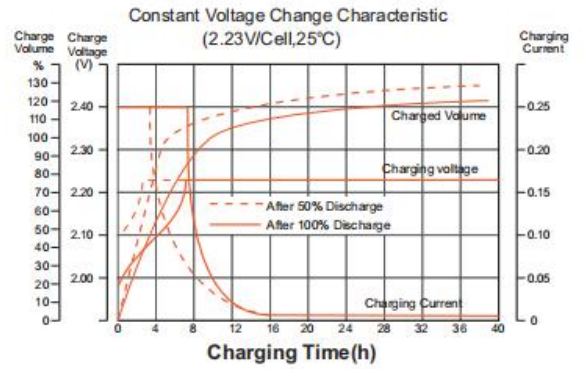

Cycle life of Different DOD

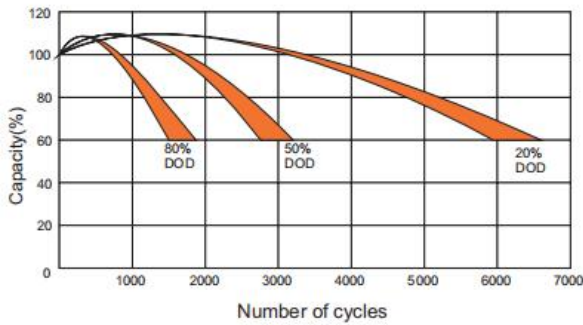

Temperature effects on capacity

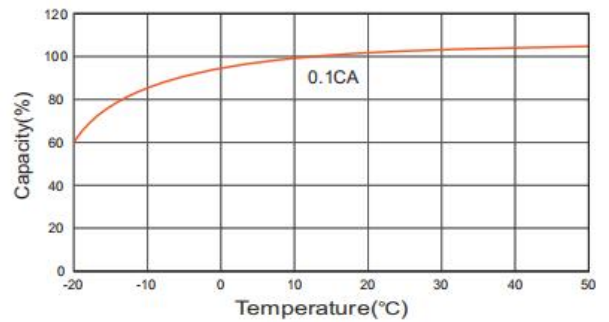

Charging voltage and temperature relationship

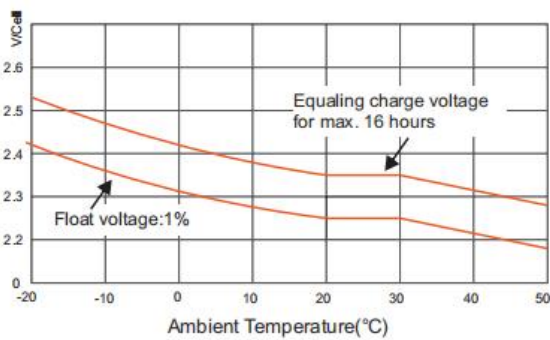

Self discharge Characteristics

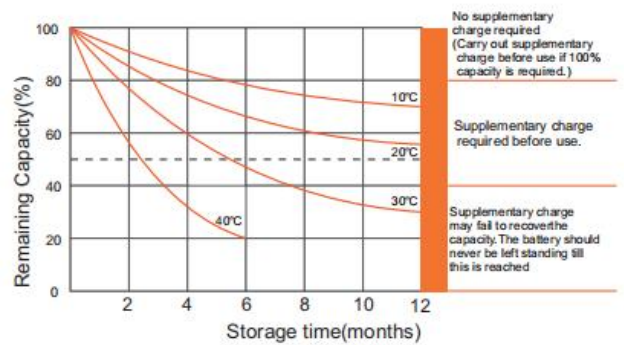

Temperature effects on floating life

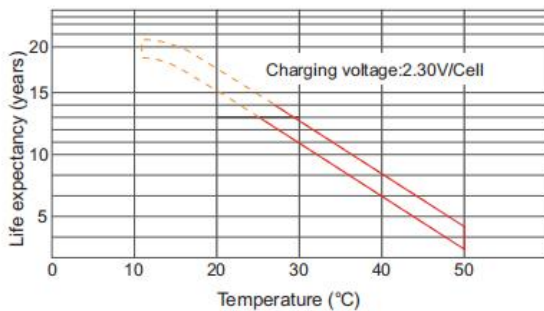

Life characteristics of standby use

